

LEGEND:

- LANDS IN THE OWNERSHIP OF THE APPLICANT/ LANDOWNER.
- PROPOSED SID APPLICATION SITE BOUNDARY
- PROPOSED COMPOUND FENCE
- PROPOSED ASPHALT ROAD
- PROPOSED STONED AREA
- PROPOSED CONCRETE FOOTPATH
- PROPOSED CONCRETE SLAB
- PROPOSED ASPHALT SURFACE
- PROPOSED MAINTENANCE GRAVEL ROAD
- PROPOSED LANDSCAPING
- PROPOSED UNIT SUB
- PROPOSED MARSHALLING KIOSK
- PROPOSED LEVEL
- EXISTING LEVEL
- PROPOSED MASTS
- PROPOSED SAND PIT
- PERMITTED 2.4m PALISADE SECURITY FENCE
- PERMITTED ASPHALT ROAD
- PERMITTED EMBANKMENT AREA
- PERMITTED CONCRETE FOOTPATH
- EXISTING 110KV OVERHEAD LINE
- EXISTING 38KV OVERHEAD LINE

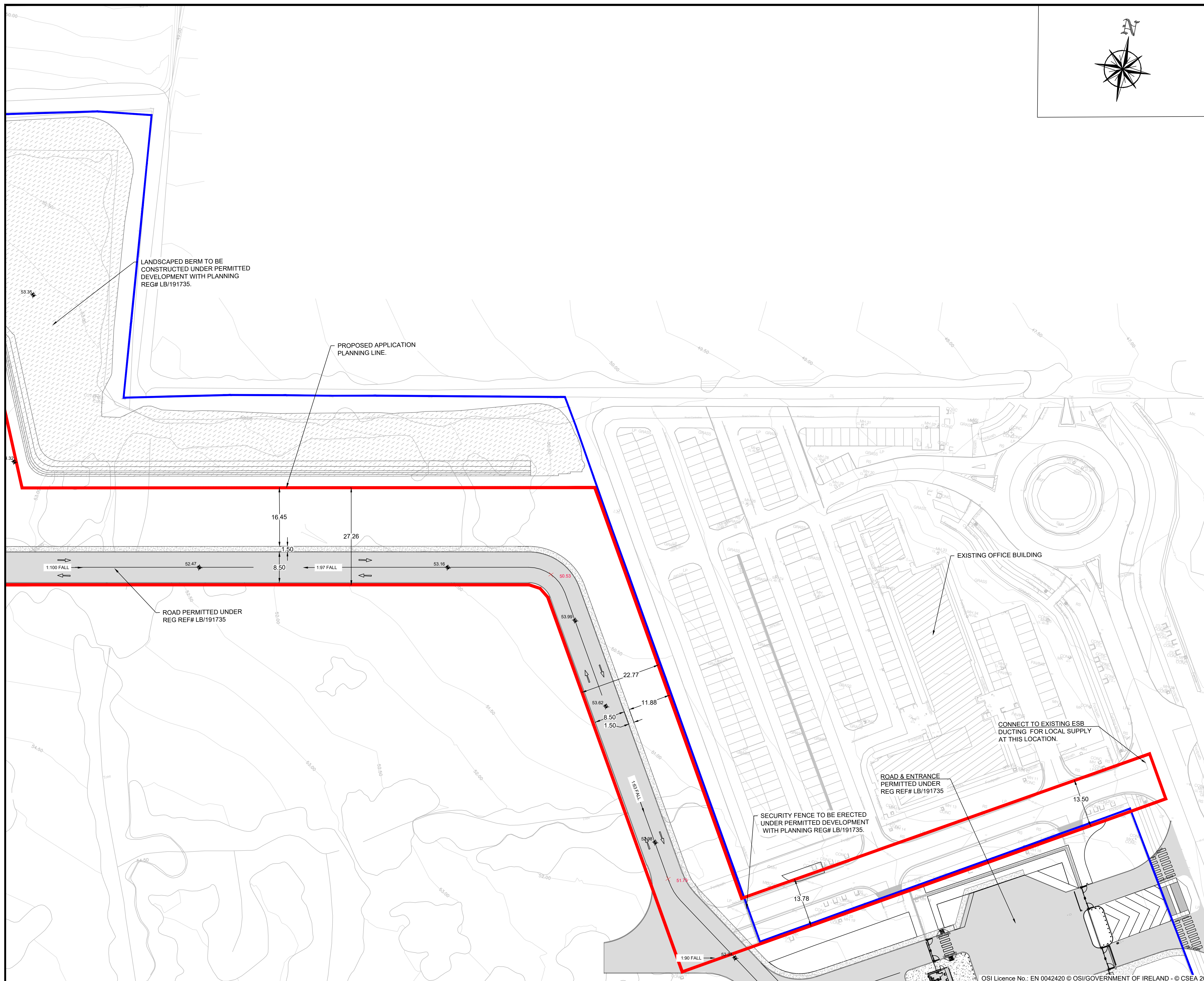

P06	SID ISSUE	DM	PM	05.11.2020
P05	SID ISSUE	DM	PM	03.11.2020
P04	EIRGRID REVIEW	DM	PM	13.10.2020
P03	DP01 ISSUE	DM	PM	10.09.2020
P02	FOR DISCUSSION	DM	PM	28.08.2020
P01	FOR DISCUSSION	DM	PM	25.08.2020
Rev	Description	Drawn	Checked	Date

Clifton Scannell Emerson Associates

Clifton Scannell Emerson Associates Limited
Consulting Engineers,
Seafor Lodge,
Castledawson Avenue,
Blackrock, Co. Dublin,
Ireland, A94 P768

T: +353 1 288 5006
F: +353 1 283 3466
E: info@csea.ie
W: www.csea.ie

CAP DEVELOPMENTS LLC

Client: **OLDBRIDGE 110KV SUBSTATION**

Project: **PROPOSED SITE LAYOUT PLAN & SITE LEVELS - SHEET 2**

Dwg. Title: **20_057**

Drawn By: **DM** Date: **OCTOBER 2020**

Checked By: **PM** Scale: **1:500 @ A1** CSEA Job No.

Project Code: **CAP - CSE - 00 - XX - DR - C - 2105**

Status Code: **S2** Suitability Description: **SUITABLE FOR INFORMATION**

Revision: **P06** Project Status: **PLANNING**